

LIFTING HOOKS : ALLOY STEEL FOUNDRY HOOKS

- Manufactured to exceed all ASME B30.20 and OSHA regulations.
- Corrosion resistant finish.
- Durable construction ideally suited to jobsite or warehouse use.
- Made in U.S.A.
- Tapered tip.
- Available in long and short reach.
- **Maximum use temperature is 400° F.**
- ±4% on dimensions.
- Custom designs available - call for engineering.
- All eyes welded unless otherwise specified.

 Prop 65 – See Page 104

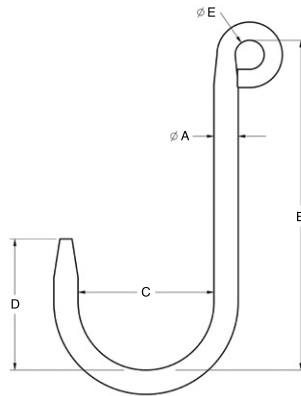
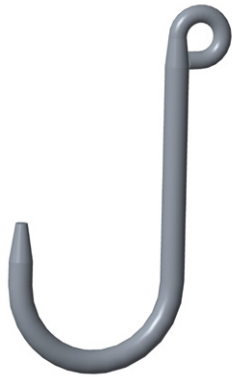

| Material ØA in Inches* | Part Number | Long Reach Foundry Hooks | | | | | Working Load Limit in Pounds* | Weight LBS |
|---------------------------|--------------|--------------------------|------|------|------|------|-------------------------------------|------------|
| | | A | B | C | D | E | | |
| 1/2 | 14601 | 0.50 | 6.00 | 2.50 | 2.31 | 0.75 | 500 | .90 |
| 5/8 | 14602 | 0.62 | 8.50 | 3.50 | 3.38 | 0.75 | 800 | 1.4 |
| 3/4 | 14603 | 0.75 | 8.50 | 3.50 | 3.38 | 0.75 | 1,250 | 2.0 |
| 13/16 | 14604 | 0.81 | 8.50 | 3.50 | 3.25 | 0.88 | 1,600 | 2.5 |
| 1 | 14605 | 1.00 | 8.50 | 4.00 | 3.75 | 1.00 | 2,500 | 4.0 |

*Larger capacities and custom configurations available. Please call for ordering assistance.

| Material ØA in Inches* | Part Number | Short Reach Foundry Hooks | | | | | Working Load Limit in Pounds* | Weight LBS |
|---------------------------|--------------|---------------------------|------|------|------|------|-------------------------------------|------------|
| | | A | B | C | D | E | | |
| 1/2 | 14782 | 0.50 | 6.00 | 3.00 | 3.00 | 0.75 | 450 | .90 |
| 5/8 | 14783 | 0.62 | 6.00 | 3.00 | 3.00 | 0.75 | 900 | 1.4 |
| 3/4 | 14784 | 0.75 | 6.00 | 3.00 | 3.00 | 0.75 | 1,400 | 2.0 |
| 13/16 | 14785 | 0.81 | 6.00 | 3.00 | 3.00 | 0.88 | 2,000 | 2.5 |
| 1 | 14786 | 1.00 | 6.00 | 3.00 | 3.00 | 1.00 | 3,000 | 4.0 |

*Larger capacities and custom configurations available. Please call for ordering assistance.