

## BEAM CLAMPS

Small Frame

### SMALL FRAME BEAM CLAMPS

- Manufactured to exceed all ASME B30.20 and OSHA regulations.
- Painted safety yellow for increased visibility.
- Do not side load above angles of 45° from vertical.
- Durable construction ideally suited to jobsite or warehouse use.
- Made in U.S.A.
- Custom designs available - call for engineering.
- **ALL** lifting equipment individually proof loaded per OSHA requirements.

 Prop 65 – See Page 104

- Refer to side loading table below for reduction factors for side loading applications.
- Clamps to be used for lifting, pulling or as an anchor point.
- Ratings apply to clamps only. User is responsible for engineering calculations for all support steelwork.

**WARNING:** All clamps must be correctly applied to the beam by a competent person and fully hand tightened. If in doubt, contact M&W for recommendations.

Reduction in Working Load Limits when side loads are applied				
Angle from Vertical	0°	0 - 15°	15 - 30°	30 - 45°
Reduction factor	none	20%	35%	50%

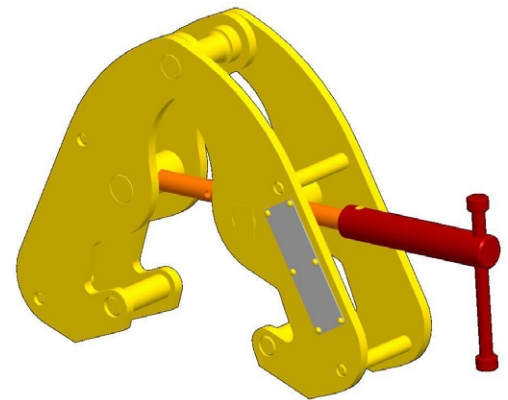
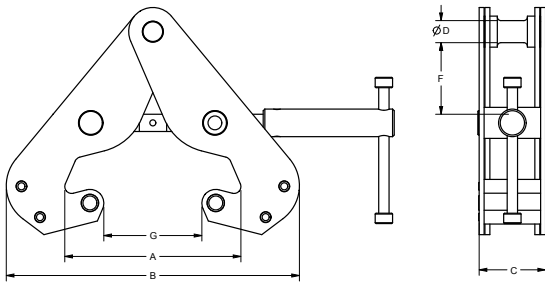
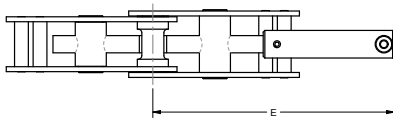

Working Load Limit in Pounds*	Part Number	A	B	C	D	E	F	G	Weight	Maximum Flange Thickness	Minimum Flange Thickness	Maximum Flange Width	Minimum Flange Width	Maximum Slip Over Width
2,240	<b>13474</b>	10.94	14.59	2.41	0.80	8.75	1.35	8.33	8.3	1.21	0.81	9.50	3.20	8.85
2,240†	<b>13510</b>	15.74	20.52	2.94	0.80	10.63	1.65	13.42	13.8	1.45	0.75	13.50	3.75	11.50
4,480	<b>13486</b>	10.94	14.59	2.94	0.80	8.75	1.35	8.33	10.4	1.21	0.87	9.60	3.20	9.00
4,480†	<b>13553</b>	15.74	20.52	3.19	0.80	10.63	1.65	13.42	16.1	1.45	0.81	14.50	3.50	14.00
6,720	<b>13497</b>	15.11	19.53	3.94	1.05	10.13	2.41	12.51	21.4	1.63	1.13	14.00	5.00	13.25
11,200	<b>13648</b>	15.11	19.53	4.19	1.38	10.13	2.24	12.51	25.6	1.63	1.13	14.00	4.25	13.00

\*Call for specifications on larger sizes and capacities. † Indicates beam clamp for use on wide flange beams.