

LIFTING HOOKS

Alloy Steel Latching J-Hooks

- Manufactured to exceed all ASME B30.20 and OSHA regulations.
- Corrosion resistant finish.
- Durable construction ideally suited to jobsite or warehouse use.
- Made in U.S.A.
- $\pm 4\%$ on dimensions.
- All eyes welded unless otherwise specified.
- **Maximum use temperature is 400° F.**

 Prop 65 – See Page 112

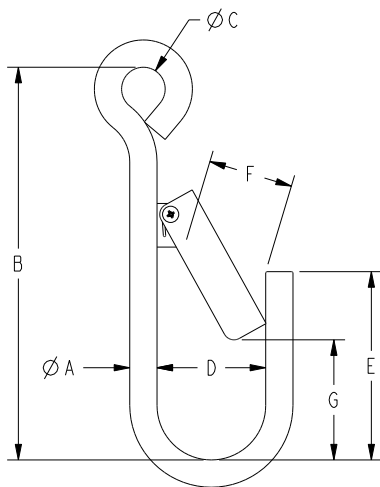

STYLE B



STYLE A



| Material ØA in Inches* | Style A Part Number | Style B Part Number | Standard Alloy Steel J-Hooks | | | | | | | Latch | Working Load Limit in Pounds* | Weight LBS |
|---------------------------|------------------------|------------------------|------------------------------|-------|------|------|------|------|-----|--------------|----------------------------------|------------|
| | | | A | B | C | D | E | F | G | | | |
| 1/4 | 16284 | 17595 | 0.25 | 4.50 | 1.00 | 1.25 | 2.00 | 0.75 | 1.2 | 23980 | 125 | .20 |
| 5/16 | 16016 | 17596 | 0.32 | 5.00 | 1.00 | 1.25 | 2.00 | 0.80 | 1.2 | 23980 | 250 | .30 |
| 3/8 | 14924 | 17611 | 0.38 | 6.00 | 1.00 | 1.50 | 2.38 | 0.96 | 1.3 | 23980 | 365 | .55 |
| 1/2 | 14767 | 17612 | 0.50 | 8.00 | 1.00 | 2.00 | 3.13 | 1.50 | 1.7 | 23981 | 650 | 1.2 |
| 5/8 | 14930 | 17613 | 0.62 | 9.00 | 1.00 | 2.50 | 4.32 | 1.76 | 2.5 | 23888 | 1,000 | 2.0 |
| 3/4 | 16383 | 17614 | 0.75 | 10.00 | 1.25 | 3.00 | 5.25 | 2.21 | 3.0 | 23889 | 1,435 | 3.4 |
| 7/8 | 16384 | 17615 | 0.88 | 12.00 | 1.25 | 3.50 | 6.25 | 2.57 | 3.5 | 23890 | 1,900 | 5.0 |
| 1 | 16385 | 17616 | 1.00 | 14.00 | 1.25 | 4.50 | 8.25 | 3.70 | 4.5 | 23891 | 2,300 | 8.0 |

*Larger capacities and custom configurations available. Please call for ordering assistance.