

Lifting Hooks : Alloy Steel J-Hooks Eye Style 9

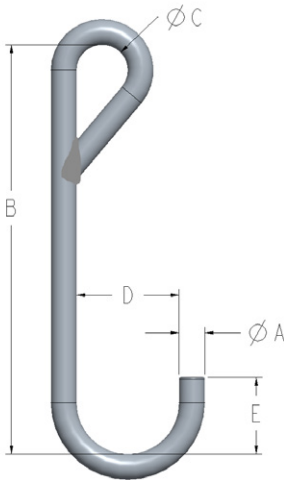

- ±4% on dimensions.
- Custom designs available - call for engineering.
- **All eyes welded unless otherwise specified.**
- Manufactured to exceed all ASME B30.20 and OSHA regulations.
- Corrosion resistant finish.
- Durable construction ideally suited to jobsite or warehouse use.
- Made in U.S.A.
- **Maximum use temperature is 400° F.**

STYLE-9

Material Diameter in Inches*	Part Number C = D = E =	Standard Alloy Style 9 Steel J-Hooks - B (length)							
		5"	6"	7"	8"	9"	10"	12"	14"
1/4 WLL= 100 Pounds	<b>Part Number</b> C = D = E =	<b>19475-5</b> 1.00 1.25 0.87	<b>19475-6</b> 1.00 1.25 0.87	<b>19475-7</b> 1.00 1.25 0.87	<b>19475-8</b> 1.00 1.25 0.87	<b>19475-9</b> 1.00 1.25 0.87	<b>19475-10</b> 1.00 1.25 0.87	<b>19475-12</b> 1.00 1.25 0.87	<b>19475-14</b> 1.00 1.25 0.87
5/16 WLL= 250 Pounds	<b>Part Number</b> C = D = E =	<b>19476-5</b> 1.00 1.25 0.87	<b>19476-6</b> 1.00 1.25 0.87	<b>19476-7</b> 1.00 1.25 0.87	<b>19476-8</b> 1.00 1.25 0.87	<b>19476-9</b> 1.00 1.25 0.87	<b>19476-10</b> 1.00 1.25 0.87	<b>19476-12</b> 1.00 1.25 0.87	<b>19476-14</b> 1.00 1.25 0.87
3/8 WLL= 365 Pounds	<b>Part Number</b> C = D = E =	<b>19477-5</b> 1.00 1.50 1.12	<b>19477-6</b> 1.00 1.50 1.12	<b>19477-7</b> 1.00 1.50 1.12	<b>19477-8</b> 1.00 1.50 1.12	<b>19477-9</b> 1.00 1.50 1.12	<b>19477-10</b> 1.00 1.50 1.12	<b>19477-12</b> 1.00 1.50 1.12	<b>19477-14</b> 1.00 1.50 1.12
1/2 WLL= 650 Pounds	<b>Part Number</b> C = D = E =	<b>19478-5</b> 1.00 2.00 1.50	<b>19478-6</b> 1.00 2.00 1.50	<b>19478-7</b> 1.00 2.00 1.50	<b>19478-8</b> 1.00 2.00 1.50	<b>19478-9</b> 1.00 2.00 1.50	<b>19478-10</b> 1.00 2.00 1.50	<b>19478-12</b> 1.00 2.00 1.50	<b>19478-14</b> 1.00 2.00 1.50
5/8 WLL= 1,000 Pounds	<b>Part Number</b> C = D = E =	<b>19479-5</b> 1.00 2.50 1.87	<b>19479-6</b> 1.00 2.50 1.87	<b>19479-7</b> 1.00 2.50 1.87	<b>19479-8</b> 1.00 2.50 1.87	<b>19479-9</b> 1.00 2.50 1.87	<b>19479-10</b> 1.00 2.50 1.87	<b>19479-12</b> 1.00 2.50 1.87	<b>19479-14</b> 1.00 2.50 1.87
3/4 WLL= 1,450 Pounds	<b>Part Number</b> C = D = E =		<b>19480-6</b> 1.00 3.00 2.25	<b>19480-7</b> 1.00 3.00 2.25	<b>19480-8</b> 1.00 3.00 2.25	<b>19480-9</b> 1.00 3.00 2.25	<b>19480-10</b> 1.00 3.00 2.25	<b>19480-12</b> 1.00 3.00 2.25	<b>19480-14</b> 1.00 3.00 2.25
7/8 WLL= 1,900 Pounds	<b>Part Number</b> C = D = E =				<b>19481-8</b> 1.00 3.50 2.62	<b>19481-9</b> 1.00 3.50 2.62	<b>19481-10</b> 1.00 3.50 2.62	<b>19481-12</b> 1.00 3.50 2.62	<b>19481-14</b> 1.00 3.50 2.62
1" WLL= 2,600 Pounds	<b>Part Number</b> C = D = E =						<b>19482-10</b> 1.25 4.00 3.00	<b>19482-12</b> 1.25 4.00 3.00	<b>19482-14</b> 1.25 4.00 3.00

\*Larger capacities and custom configurations available. Please call for ordering assistance.