

Lifting Hooks : Alloy Steel J-Hooks Eye Style B

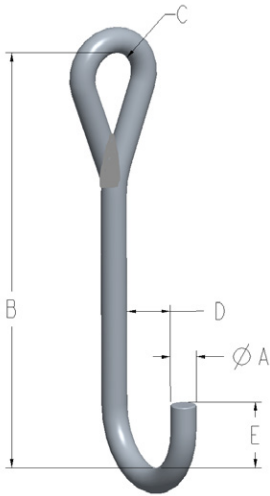

- ±4% on dimensions.
- Custom designs available - call for engineering.
- All eyes welded unless otherwise specified.
- Manufactured to exceed all ASME B30.20 and OSHA regulations.
- Corrosion resistant finish.
- Durable construction ideally suited to jobsite or warehouse use.
- Made in U.S.A.
- **Maximum use temperature is 400° F.**

STYLE-B

Material Diameter in Inches*	Part Number C = D = E =	Standard Alloy Style B Steel J-Hooks - B (length)						
		6"	7"	8"	9"	10"	12"	14"
1/4 WLL= 100 Pounds	Part Number C = D = E =	11637-6 1.00 1.25 0.87	11637-7 1.00 1.25 0.87	11637-8 1.00 1.25 0.87	11637-9 1.00 1.25 0.87	11637-10 1.00 1.25 0.87	11637-12 1.00 1.25 0.87	11637-14 1.00 1.25 0.87
5/16 WLL= 250 Pounds	Part Number C = D = E =	11638-6 1.00 1.25 0.87	11638-7 1.00 1.25 0.87	11638-8 1.00 1.25 0.87	11638-9 1.00 1.25 0.87	11638-10 1.00 1.25 0.87	11638-12 1.00 1.25 0.87	11638-14 1.00 1.25 0.87
3/8 WLL= 365 Pounds	Part Number C = D = E =	11639-6 1.00 1.50 1.12	11639-7 1.00 1.50 1.12	11639-8 1.00 1.50 1.12	11639-9 1.00 1.50 1.12	11639-10 1.00 1.50 1.12	11639-12 1.00 1.50 1.12	11639-14 1.00 1.50 1.12
1/2 WLL= 650 Pounds	Part Number C = D = E =	11640-6 1.00 2.00 1.50	11640-7 1.00 2.00 1.50	11640-8 1.00 2.00 1.50	11640-9 1.00 2.00 1.50	11640-10 1.00 2.00 1.50	11640-12 1.00 2.00 1.50	11640-14 1.00 2.00 1.50
5/8 WLL= 1,000 Pounds	Part Number C = D = E =	11641-6 1.00 2.50 1.87	11641-7 1.00 2.50 1.87	11641-8 1.00 2.50 1.87	11641-9 1.00 2.50 1.87	11641-10 1.00 2.50 1.87	11641-12 1.00 2.50 1.87	11641-14 1.00 2.50 1.87
3/4 WLL= 1,450 Pounds	Part Number C = D = E =	11642-6 1.00 3.00 2.25	11642-7 1.00 3.00 2.25	11642-8 1.00 3.00 2.25	11642-9 1.00 3.00 2.25	11642-10 1.00 3.00 2.25	11642-12 1.00 3.00 2.25	11642-14 1.00 3.00 2.25
7/8 WLL= 1,900 Pounds	Part Number C = D = E =			11643-8 1.00 3.50 2.62	11643-9 1.00 3.50 2.62	11643-10 1.00 3.50 2.62	11643-12 1.00 3.50 2.62	11643-14 1.00 3.50 2.62
1" WLL= 2,600 Pounds	Part Number C = D = E =					11644-10 1.25 4.00 3.00	11644-12 1.25 4.00 3.00	11644-14 1.25 4.00 3.00

*Larger capacities and custom configurations available. Please call for ordering assistance.