

Lifting Hooks : Alloy Steel J-Hooks Eye Style C

- ±4% on dimensions.
- Custom designs available - call for engineering.
- All eyes welded unless otherwise specified.
- Manufactured to exceed all ASME B30.20 and OSHA regulations.
- Corrosion resistant finish.
- Durable construction ideally suited to jobsite or warehouse use.
- Made in U.S.A.
- **Maximum use temperature is 400° F.**

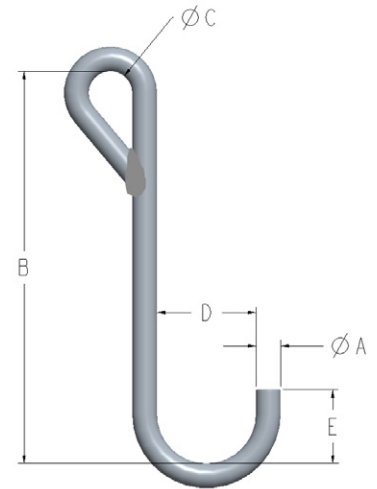

STYLE-C

Material Diameter in Inches*	Part Number C = D = E =	Standard Alloy Style C Steel J-Hooks - B (length)							
		5"	6"	7"	8"	9"	10"	12"	14"
1/4 WLL= 100 Pounds	Part Number C = D = E =	11653-5 1.00 1.25 0.87	11653-6 1.00 1.25 0.87	11653-7 1.00 1.25 0.87	11653-8 1.00 1.25 0.87	11653-9 1.00 1.25 0.87	11653-10 1.00 1.25 0.87	11653-12 1.00 1.25 0.87	11653-14 1.00 1.25 0.87
5/16 WLL= 250 Pounds	Part Number C = D = E =	11654-5 1.00 1.25 0.87	11654-6 1.00 1.25 0.87	11654-7 1.00 1.25 0.87	11654-8 1.00 1.25 0.87	11654-9 1.00 1.25 0.87	11654-10 1.00 1.25 0.87	11654-12 1.00 1.25 0.87	11654-14 1.00 1.25 0.87
3/8 WLL= 365 Pounds	Part Number C = D = E =	11655-5 1.00 1.50 1.12	11655-6 1.00 1.50 1.12	11655-7 1.00 1.50 1.12	11655-8 1.00 1.50 1.12	11655-9 1.00 1.50 1.12	11655-10 1.00 1.50 1.12	11655-12 1.00 1.50 1.12	11655-14 1.00 1.50 1.12
1/2 WLL= 650 Pounds	Part Number C = D = E =	11656-5 1.00 2.00 1.50	11656-6 1.00 2.00 1.50	11656-7 1.00 2.00 1.50	11656-8 1.00 2.00 1.50	11656-9 1.00 2.00 1.50	11656-10 1.00 2.00 1.50	11656-12 1.00 2.00 1.50	11656-14 1.00 2.00 1.50
5/8 WLL= 1,000 Pounds	Part Number C = D = E =	11657-5 1.00 2.50 1.87	11657-6 1.00 2.50 1.87	11657-7 1.00 2.50 1.87	11657-8 1.00 2.50 1.87	11657-9 1.00 2.50 1.87	11657-10 1.00 2.50 1.87	11657-12 1.00 2.50 1.87	11657-14 1.00 2.50 1.87
3/4 WLL= 1,450 Pounds	Part Number C = D = E =		11658-6 1.00 3.00 2.25	11658-7 1.00 3.00 2.25	11658-8 1.00 3.00 2.25	11658-9 1.00 3.00 2.25	11658-10 1.00 3.00 2.25	11658-12 1.00 3.00 2.25	11658-14 1.00 3.00 2.25
7/8 WLL= 1,900 Pounds	Part Number C = D = E =				11659-8 1.00 3.50 2.62	11659-9 1.00 3.50 2.62	11659-10 1.00 3.50 2.62	11659-12 1.00 3.50 2.62	11659-14 1.00 3.50 2.62
1" WLL= 2,600 Pounds	Part Number C = D = E =						11660-10 1.25 4.00 3.00	11660-12 1.25 4.00 3.00	11660-14 1.25 4.00 3.00

*Larger capacities and custom configurations available. Please call for ordering assistance.