

**Lifting Hooks : Alloy Steel J-Hooks Eye Style A**

- ±4% on dimensions.
- Custom designs available - call for engineering.
- **All eyes welded unless otherwise specified.**
- Manufactured to exceed all ASME B30.20 and OSHA regulations.
- Corrosion resistant finish.
- Durable construction ideally suited to jobsite or warehouse use.
- Made in U.S.A.
- **Maximum use temperature is 400° F.**

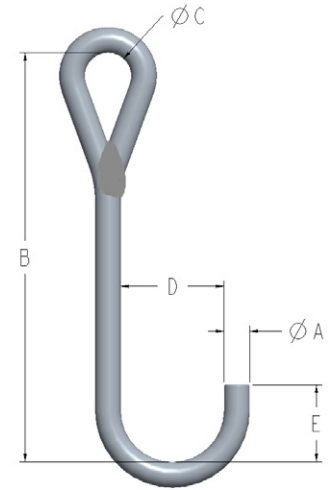

**STYLE-A**

Material Diameter in Inches*	Part Number C = D = E =	Standard Alloy Style A Steel J-Hooks - B (length)							
		5"	6"	7"	8"	9"	10"	12"	14"
1/4 WLL= 100 Pounds	<b>Part Number</b> C = D = E =	<b>11621-5</b> 1.00 1.25 0.87	<b>11621-6</b> 1.00 1.25 0.87	<b>11621-7</b> 1.00 1.25 0.87	<b>11621-8</b> 1.00 1.25 0.87	<b>11621-9</b> 1.00 1.25 0.87	<b>11621-10</b> 1.00 1.25 0.87	<b>11621-12</b> 1.00 1.25 0.87	<b>11621-14</b> 1.00 1.25 0.87
5/16 WLL= 250 Pounds	<b>Part Number</b> C = D = E =	<b>11622-5</b> 1.00 1.25 0.87	<b>11622-6</b> 1.00 1.25 0.87	<b>11622-7</b> 1.00 1.25 0.87	<b>11622-8</b> 1.00 1.25 0.87	<b>11622-9</b> 1.00 1.25 0.87	<b>11622-10</b> 1.00 1.25 0.87	<b>11622-12</b> 1.00 1.25 0.87	<b>11622-14</b> 1.00 1.25 0.87
3/8 WLL= 365 Pounds	<b>Part Number</b> C = D = E =	<b>11623-5</b> 1.00 1.50 1.12	<b>11623-6</b> 1.00 1.50 1.12	<b>11623-7</b> 1.00 1.50 1.12	<b>11623-8</b> 1.00 1.50 1.12	<b>11623-9</b> 1.00 1.50 1.12	<b>11623-10</b> 1.00 1.50 1.12	<b>11623-12</b> 1.00 1.50 1.12	<b>11623-14</b> 1.00 1.50 1.12
1/2 WLL= 650 Pounds	<b>Part Number</b> C = D = E =	<b>11624-5</b> 1.00 2.00 1.50	<b>11624-6</b> 1.00 2.00 1.50	<b>11624-7</b> 1.00 2.00 1.50	<b>11624-8</b> 1.00 2.00 1.50	<b>11624-9</b> 1.00 2.00 1.50	<b>11624-10</b> 1.00 2.00 1.50	<b>11624-12</b> 1.00 2.00 1.50	<b>11624-14</b> 1.00 2.00 1.50
5/8 WLL= 1,000 Pounds	<b>Part Number</b> C = D = E =	<b>11625-5</b> 1.00 2.50 1.87	<b>11625-6</b> 1.00 2.50 1.87	<b>11625-7</b> 1.00 2.50 1.87	<b>11625-8</b> 1.00 2.50 1.87	<b>11625-9</b> 1.00 2.50 1.87	<b>11625-10</b> 1.00 2.50 1.87	<b>11625-12</b> 1.00 2.50 1.87	<b>11625-14</b> 1.00 2.50 1.87
3/4 WLL= 1,450 Pounds	<b>Part Number</b> C = D = E =		<b>11626-6</b> 1.00 3.00 2.25	<b>11626-7</b> 1.00 3.00 2.25	<b>11626-8</b> 1.00 3.00 2.25	<b>11626-9</b> 1.00 3.00 2.25	<b>11626-10</b> 1.00 3.00 2.25	<b>11626-12</b> 1.00 3.00 2.25	<b>11626-14</b> 1.00 3.00 2.25
7/8 WLL= 1,900 Pounds	<b>Part Number</b> C = D = E =				<b>11627-8</b> 1.00 3.50 2.62	<b>11627-9</b> 1.00 3.50 2.62	<b>11627-10</b> 1.00 3.50 2.62	<b>11627-12</b> 1.00 3.50 2.62	<b>11627-14</b> 1.00 3.50 2.62
1" WLL= 2,600 Pounds	<b>Part Number</b> C = D = E =						<b>11628-10</b> 1.25 4.00 3.00	<b>11628-12</b> 1.25 4.00 3.00	<b>11628-14</b> 1.25 4.00 3.00

\*Larger capacities and custom configurations available. Please call for ordering assistance.